

OCEAN CITY "SHORELINE" REEL NO. 125  
(Model B)

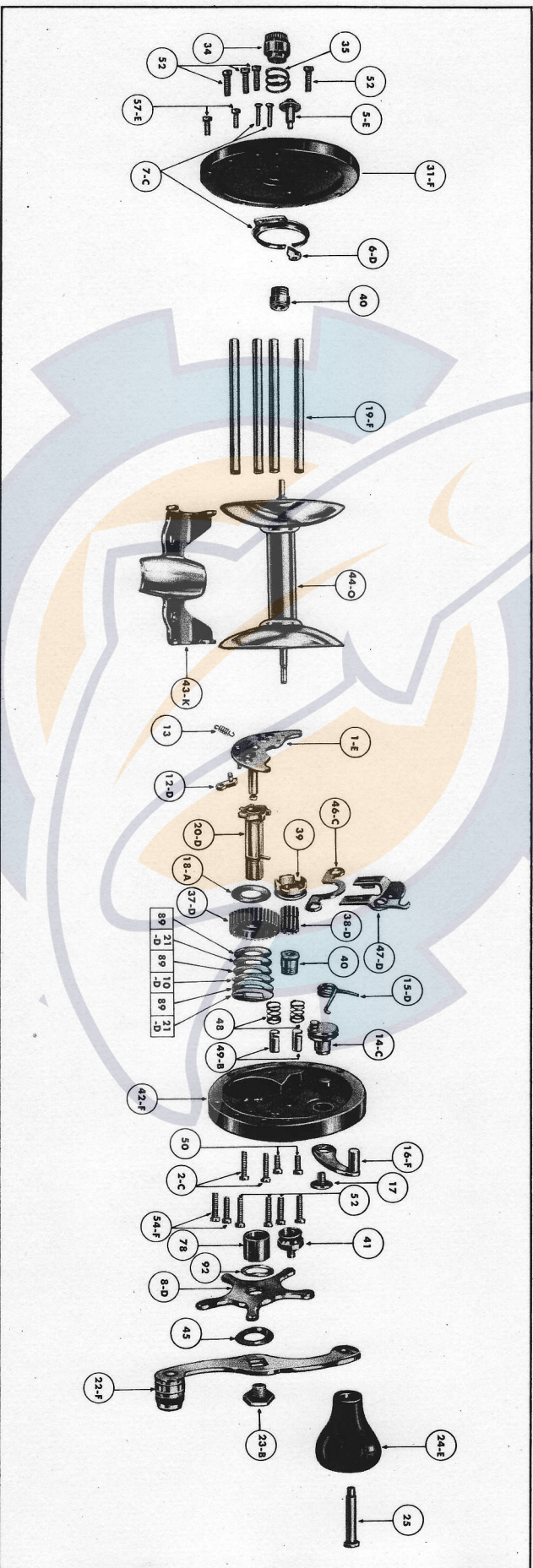

HOW TO ORDER PARTS FOR YOUR REEL—Locate the part desired in the illustration above and note part number. When ordering, state quantity, part number, part name and model letter which you will find on underside of reel stand. Enclose money order, stamps or check. Our minimum charge for one order is \$.25; please add \$.15 on each order for return postage and insurance.

Part No.	Part Name	Price	Part No.	Part Name	Price	Part No.	Part Name	Price	Part No.	Part Name	Price
1-E	Bridge	.35	16-F	Free Spool Lever	.24	31-F	Left Side Plate Complete with Part Nos. 5-E, 7-C and 6-D	.80	45	Drag Star Top Washer	.04
2-C	Bridge Screw	.02	17	Free Spool Lever Screw	.05	34	Left Side Oil Cap	.12	46-C	Yoke	.20
5-E	Click Button	.12	18-A	Drag Fiber Washer	.01	35	Left Side Oil Cap Spring	.04	47-D	Yoke Plate	.26
6-D	Click Pawl	.12	19-F	Frame Post	.12	37-D	Main Gear	.45	48	Yoke Spring	.04
7-C	Click Spring (With Rivets)	.14	20-D	Gear Sleeve and Lock Pin	.60	38-D	Pinion Gear	.30	49-B	Yoke Guide Stud	.02
8-D	Drag Star	.32	21-D	Drag Lock Washer	.05	39	Pinion Gear Clutch	.26	50	Yoke Guide Stud Screw	.02
10-D	Drag Eared Washer	.05	22-F	Handle Complete with Part Nos. 24-E and 25	.80	40	Left and Right Side Bearing	.20	52	Screw, Left and Right Side Plate	.02
12-D	Drag Dog	.10	23-B	Handle Screw	.10	41	Right Side Adjusting Cap	.12	54-F	Screw, Right Side Stand	.02
13	Drag Dog Spring	.03	24-E	Handle Knob	.14	42-F	Right Side Side Plate	.80	57-E	Gear Sleeve Bushing	.08
14-C	Eccentric	.50	25	Handle Knob Rivet	.06	43-K	Stand	.80	78	Drag Laminated Washer	.02
15-D	Eccentric Spring	.12				44-O	Spool	1.00	92	Drag Star Bottom Washer	.05